

TECHNICAL SPECIFICATION

Measuring module S36-D1Y /S36-D3Y		
Accuracy		U, I: 0.2%; P: 0.5%; Hz:±0.01Hz; Active energy: Class 0.5S, Reactive energy: Class 2
Rated voltage	Three-phase	AC 3*230/400V
	Single-phase	AC 230V
Input current	Direct	AC 0.1-0.5(80)A
Frequency		50/60 Hz
Wiring mode		S36-D1Y: single-phase S36-D3Y: 3P4W
Consumption	Voltage circuit	< 1VA
	Current circuit	< 1VA
Start-up current	Access via CT	0.004Ib
I/O characteristic		
Digital input		AC wet contact, ON: AC 180...270V, OFF: < AC 100V
Relay output		Contact capacity: 90A/250V AC
Energy pulse		Pulse width 80ms±20ms
Mechanical characteristic		
Dimension		72×120×80mm
Protection degree		IP54 (Front case)
Ambient condition		
Working temperature		-25°C - +70°C
Relative humidity		5%-95%RH, No condensation

DDS/DSS/DTS1946 Series



Modbus Interface
Programmable
DIN Rail Mounted



MAIN FEATURES

- Measuring**
 -Direct measurement up to 100A
- Communication**
 -Interface: RS485
 -Protocol: Modbus-RTU
- Energy Metering**
 -Bi-directional energy
 -Tariff energy

APPLICATIONS



Energy
Management



Sub-item
Metering



Power
Monitoring

COMPARISON TABLE



Model	DDS1946-1P+	DDSF1946-1P+	DDS1946-2M	DDSF1946-2M	DDS1946-2P-M	DDSF1946-2P-M	DDS1946	DDSF1946	DDS1946-T	DDSF1946-T
Wiring Method	Up in down out				Down in down out					
Accuracy	Class 1	Class 1	Class B	Class B	Class 1	Class 1	Class 0.5	Class 0.5	Class 0.5S	Class 0.5S
Wiring	1P2W	1P2W	1P2W	1P2W	1P2W	1P2W	1P2W	1P2W	1P2W	1P2W
Voltage	230V	230V	230V	230V	230V	230V	230V	230V	230V	230V
Current	Direct	0.5-10(100)A	0.5-10(100)A	0.25-5(63)A	0.25-5(63)A	0.25-5(63)A	0.25-5(100)A	0.25-5(100)A	-	-
	Via CT	-	-	-	-	-	-	-	0.05-5(6)A	0.05-5(6)A
Measuring	Voltage	■	■	■	■	■	■	■	■	■
	Current	■	■	■	■	■	■	■	■	■
	Power	■	■	■	■	■	■	■	■	■
	Power factor	■	■	■	■	■	■	■	■	■
	Frequency	■	■	■	■	■	■	■	■	■
Energy Metering	±kWh	■	■	■	■	■	■	■	■	■
	Tariffs energy	-	■	-	■	-	■	-	■	■
Width(mm)	18	18	36	36	36	36	72	72	72	72
Communicaton	Modbus-RTU	■	■	■	■	■	■	■	■	■
	MBUS	-	-	-	-	■	■	-	-	-
Energy Pulse	-	-	■	■	■	■	■	■	■	■
Display Mode	LCD	LCD	LCD	LCD	LCD	LCD	LCD	LCD	LCD	LCD

NOTE: "■": Yes "-": No

COMPARISON TABLE

MID

MID



Model	DTS1946-4M	DTSF1946-4M	DTS1946-4M-T	DTSF1946-4M-T	DTS1946-4P-M	DTSF1946-4P-M	DTS1946-4P-TM	DTSF1946-4P-TM	DSS1946	DSSF1946	DSS1946-T	DSSF1946-T	DTS1946	DTSF1946	DTS1946-T	DTSF1946-T		
Wiring Method	Up in down out							Down in down out										
Accuracy	Class B	Class B	Class 0.5S	Class 0.5S	Class 1	Class 1	Class 0.5S	Class 0.5S	Class 0.5	Class 0.5	Class 0.5	Class 0.5S	Class 0.5S	Class 0.5	Class 0.5	Class 0.5S	Class 0.5S	
Wiring	3P4W	3P4W	3P4W	3P4W	3P4W	3P4W	3P4W	3P4W	3P4W	3P3W	3P3W	3P3W	3P3W	3P4W	3P4W	3P4W	3P4W	
Voltage	3*230/400V	3*230/400V	3*230/400V	3*230/400V	3*230/400V	3*230/400V	3*230/400V	3*230/400V	3*230/400V	3*400V	3*400V	3*400V	3*400V	3*230/400V	3*230/400V	3*230/400V	3*230/400V	
Current	Direct	0.25-5(63)A	0.25-5(63)A	-	-	0.25-5(63)A	0.25-5(63)A	-	-	0.25-5(100)A	0.25-5(100)A	-	-	0.25-5(100)A	0.25-5(100)A	-	-	
	Via CT	-	-	0.01-1(6)A	0.01-1(6)A	-	-	0.01-1(6)A	0.01-1. (6)A	-	-	0.01-1(6)A	0.01-1(6)A	-	-	0.01-1(6)A	0.01-1(6)A	
Measuring	Voltage	■	■	■	■	■	■	■	■	■	■	■	■	■	■	■	■	
	Current	■	■	■	■	■	■	■	■	■	■	■	■	■	■	■	■	
	Power	■	■	■	■	■	■	■	■	■	■	■	■	■	■	■	■	
	Power factor	■	■	■	■	■	■	■	■	■	■	■	■	■	■	■	■	■
	Frequency	■	■	■	■	■	■	■	■	■	■	■	■	■	■	■	■	■
	THD	■	■	■	■	■	■	■	■	■	■	■	■	■	■	■	■	■
Energy Metering	±kWh	■	■	■	■	■	■	■	■	■	■	■	■	■	■	■	■	
	Tariffs energy	-	■	-	■	-	■	-	■	-	■	-	■	■	■	-	■	
Width(mm)	72	72	72	72	72	72	72	72	72	126	126	126	126	126	126	126	126	
Communicaton	Modbus-RTU	■	■	■	■	■	■	■	■	■	■	■	■	■	■	■	■	
	MBUS	-	-	-	-	■	■	■	■	-	-	-	-	-	-	-	-	
Energy Pulse	■	■	■	■	■	■	■	■	■	■	■	■	■	■	■	■	■	
Display Mode	LCD	LCD	LCD	LCD	LCD	LCD	LCD	LCD	LCD	LCD	LCD	LCD	LCD	LCD	LCD	LCD	LCD	

NOTE: "■": Yes "—": No



DIMENSIONS

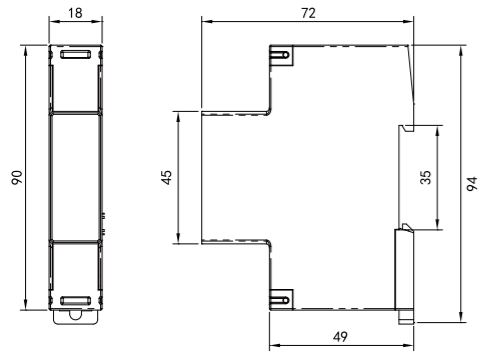

DDS1946-1P+
DDSF1946-1P+

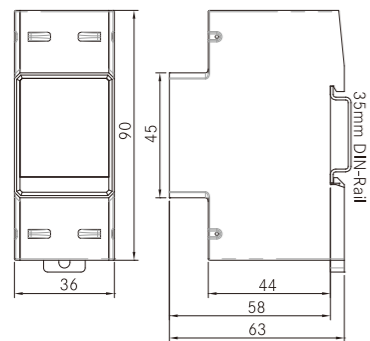

DDS(F)1946-2M
DDS(F)1946-2P-M

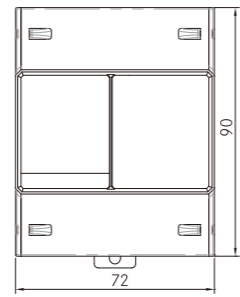

DTS(F)1946-4M
DTS(F)1946-4M-T

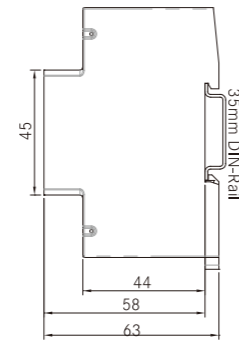

DTS(F)1946-4P-M
DTS(F)1946-4P-TM

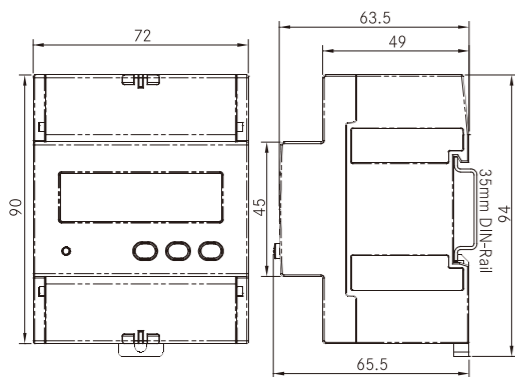

DDS(F)1946
DDS(F)1946-T

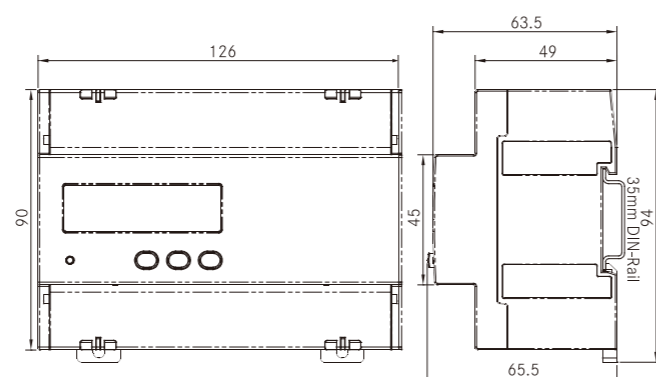

DSS(F)1946
DSS(F)1946-T

DTS(F)1946
DTS(F)1946-T



TYPICAL WIRING

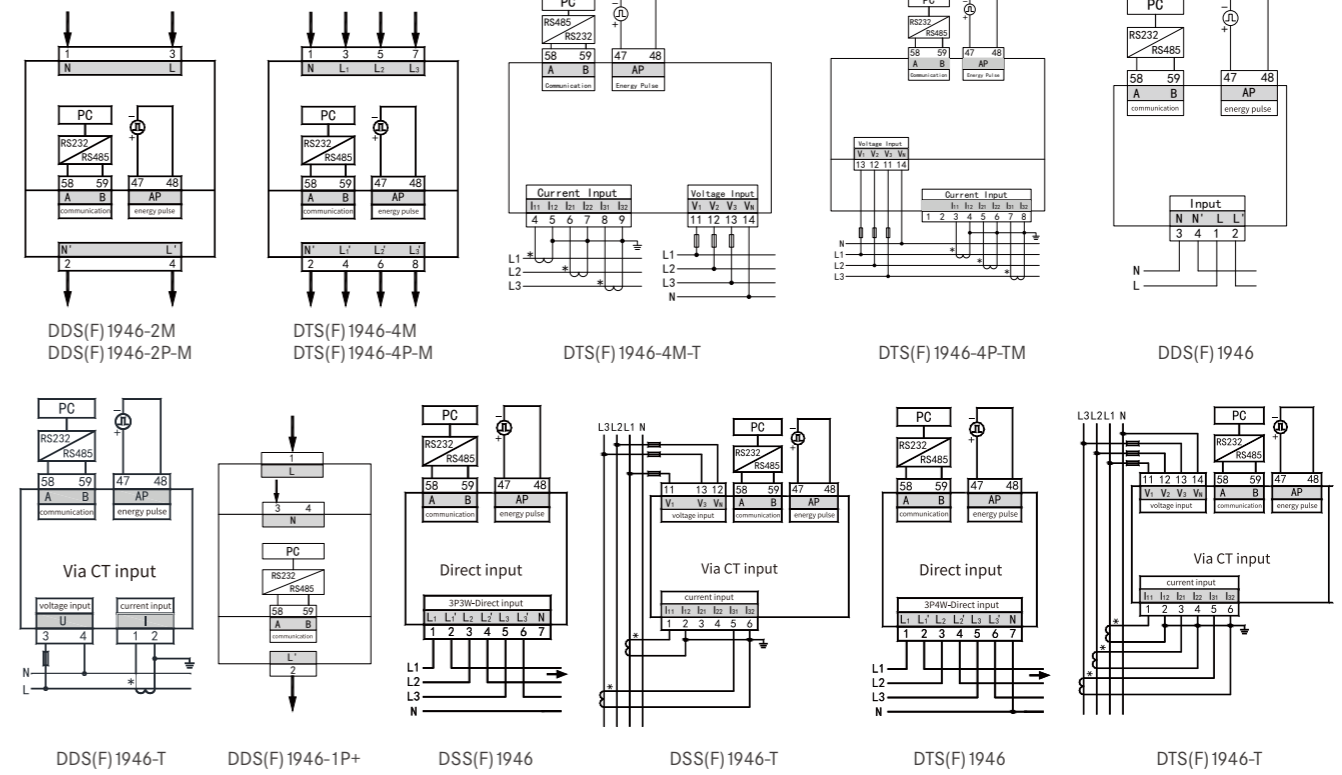

TECHNICAL SPECIFICATION

Model	DDS/DSS/DTS1946 Series
Normal voltage	230V, 3*400V, 3*230/400V
Frequency	45Hz~65 Hz
Voltage range	0.8Un~1.2Un
Start current	Direct input: 0.004Ib Via CT input: 0.001In
Consumption	< 4VA
Energy pulse	1 output, pulse width (80±20%) ms
RTC error	≤ 0.5s/day
Communication	RS485, Modbus-RTU/ MBUS protocol
IP degree	Front:IP51
Operating temperature	-25 C ~55 C
Relative humidity	≤ 93%