

# ENERGY MANAGEMENT DIN RAIL MOUNTED ENERGY METER

www.sfere-elec.net

Electrical Application Solution Expert



## APPLICATIONS

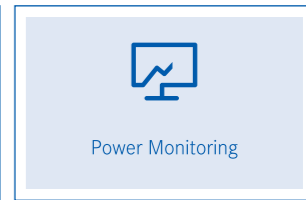
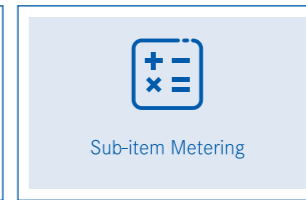

## MAIN FEATURES

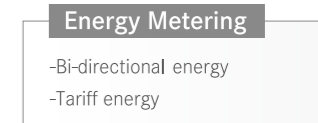
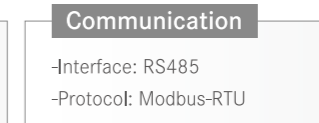
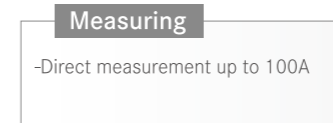

## DIMENSIONS

DDS1946-1P/DDSF1946-1P

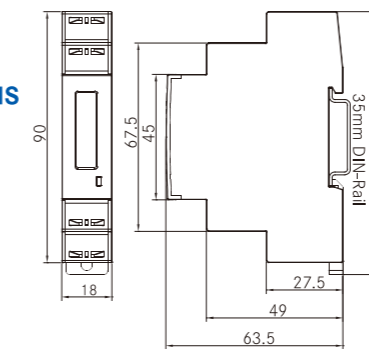

DDS1946-1P+/DDSF1946-1P+

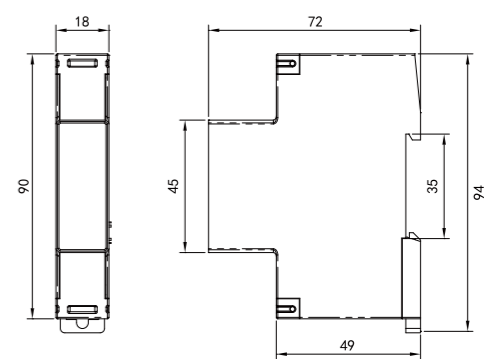

DDS1946-2P(M)/DDSF1946-2P(M)

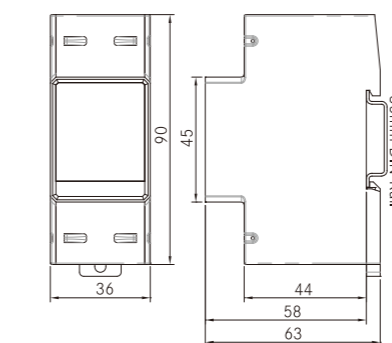

DTS1946-4P(M)/DTSF1946-4P(M)

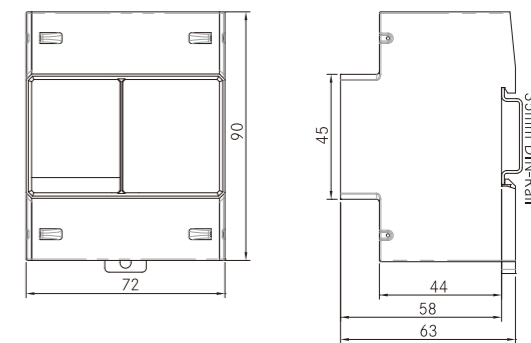

DDS1946/DDSF1946

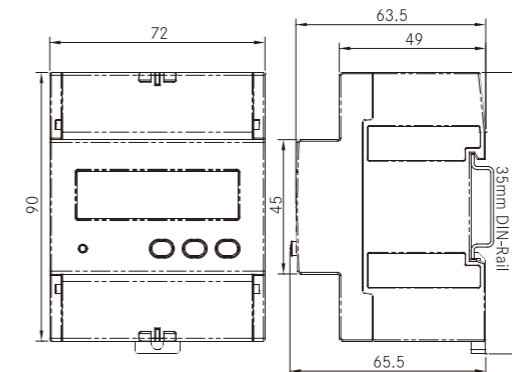

DSS1946/DSSF1946/DTS1946/DTSF1946

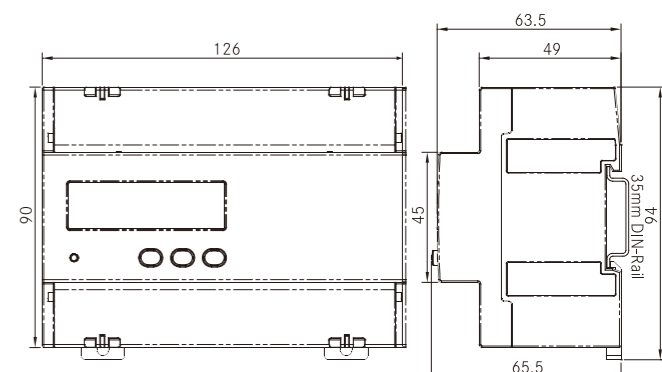



COMPARISON TABLE



Model	DDS1946-1P+ / DDSF1946-1P+	DDS1946-2M / DDSF1946-2M	DDS1946-2P / DDSF1946-2P	DTS1946-4M / DTSF1946-4M	DTS1946-4P / DTSF1946-4P	DDS1946-1P / DDSF1946-1P	DDS1946 / DDSF1946	DSS1946 / DSSF1946	DTS1946 / DTSF1946	
Wiring Method	Up In Down Out				Up In Down Out		Down In Down Out			
Accuracy	Class 1	Class B	Class 0.5S	Class B	Class 0.5S	Class 1	Class 0.5S	Class 0.5S	Class 0.5S	
Wiring	1P2W	■	■	■	—	—	■	■	—	—
	3P3W	—	—	—	—	—	—	■	—	—
	3P4W	—	—	—	■	■	—	—	—	■
Voltage	230V	■	■	■	—	■	■	—	—	—
	3×400V	—	—	—	—	—	—	■	—	—
	3×230/400V	—	—	—	■	■	—	—	—	■
Current	Direct	10(100)A	5(63)A	5(100)A	5(63)A	5(100)A	5(40)A	5(100)A	5(100)A	5(100)A
	Via CT	—	—	—	—	—	—	1.5(6)A	1.5(6)A	1.5(6)A
Measuring	Voltage	■	■	■	■	■	■	■	■	■
	Current	■	■	■	■	■	■	■	■	■
	Power	■	■	■	■	■	■	■	■	■
	Power factor	■	■	■	■	■	■	■	■	■
	Frequency	■	■	■	■	■	■	■	■	■
Energy Metering	±kWh	■	■	■	■	■	■	■	■	■
	Tariffs	— / ■	— / ■	— / ■	— / ■	— / ■	— / ■	— / ■	— / ■	— / ■
	Backup*	—	—	—	—	—	—	□	□	□
Width(mm)	18	36	36	72	72	18	72	126	126	
Communication (Modbus-RTU)	■	■	■	■	■	■	■	■	■	
Digital Input	—	—	—	—	—	—	□	□	□	
Energy Pulse	■	■	■	■	■	■	■	■	■	
Display Mode	LCD	LCD	LCD	LCD	LCD	LCD	LCD	LCD	LCD	

NOTE:1. ■: Yes —: No □: Optional

2.DDS/DDSF1946-2M and DTS/DTSF1946-2M are MID certified.

3.Only those with F in the model name have the tariffs function.

4.\*The measurement of backup energy is realized by the digital input of optional ,and a B is added after the model is selected.For example,DTSF1946B



## TYPICAL WIRING

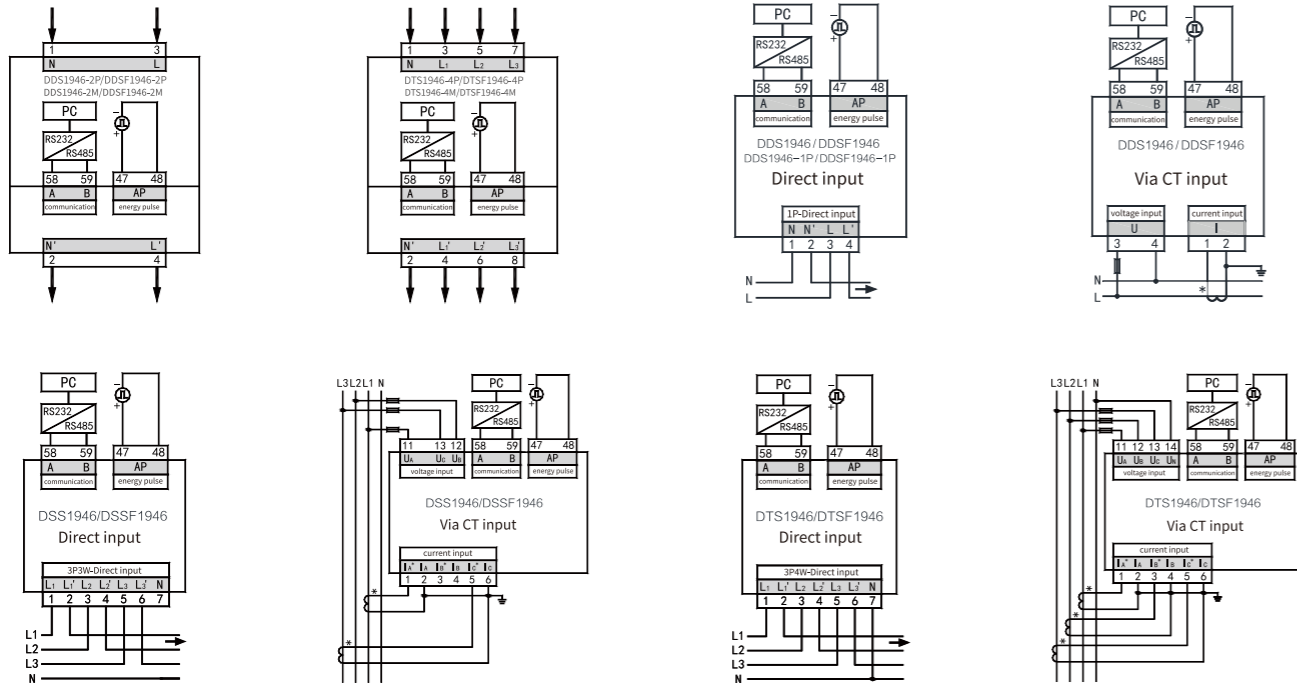

## TECHNICAL SPECIFICATION

Model	DDS(F)1946-1P DDS(F)1946-1P+	DDS(F)1946-2P DDS(F)1946-2M	DDS(F)1946	DSS(F)1946	DTS(F)1946-4P DTS(F)1946-4M	DTS(F)1946
Normal Voltage	230V	230V	230V	3×400V	3×230/400V	3×230/400V
Frequency	45Hz~65 Hz					
Voltage Range	0.8Un~1.2Un					
Start Current	Direct input	0.004Ib				
	Via CT input	0.002In				
Consumption	< 2VA					
Energy Pulse	1 output, pulse width (80±20%) ms					
Digital Input	Active digital input, input range 0~220VAC; >150VAC closed, <70VAC open.					
RTC Error	≤0.5s/day					
Communication	RS485, Modbus-RTU, 2-wire, up to 9600bps					
IP Degree	Front: IP51					
Operating Temperature	-25 C~55 C					
Storage Temperature	-25 C~70 C					
Relative Humidity	≤93%					

# DDSY1946A DTSY1946A

The Prepaid energy meter is designed by adopting advanced microprocessor and signal processing technology, and it possesses functions as below: All-parameter measurement, electric energy metering, time-division charging, prepayment, demand quantity statistic, event recording, malignant load identification, fault warning, etc.



Strong/weak Current Isolation  
Prepaid  
Bi-directional Energy  
Parameter Programmability



## COMPARISON TABLE

Model		DDSY1946A	DTSY1946A
Wiring Mode		Single phase	Three-phase four-wire
Voltage Range		230V	3 x230/400V
Current Specification	Direct access	5(80)A	5(80)A
Real-time Measurement	Voltage and current	■	■
	Power	■	■
	Power factor	■	■
	Frequency	■	■
Electric Energy Metering	Bi-directional energy	■	■
	Multi-rate electric energy	■	■
Switching Value	Switching value input (AC wet contact)	■	■
	Relay output	■	■
Communication	RS485 interface	■	■
Electric Energy Pulse/clock Pulse		■	■
Display Mode		LCD	LCD

Note: The "■" above means that the item has the corresponding function.